

PL-S SINGLE HALF-SIZE TURNSTILE

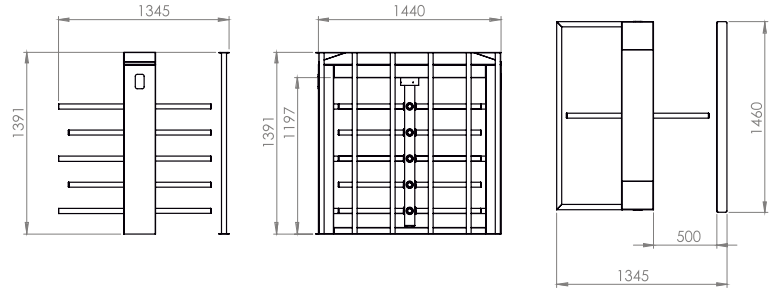

Product Specifications: Stainless Steel, painted

PL-S DOUBLE HALF-SIZE TURNSTILE

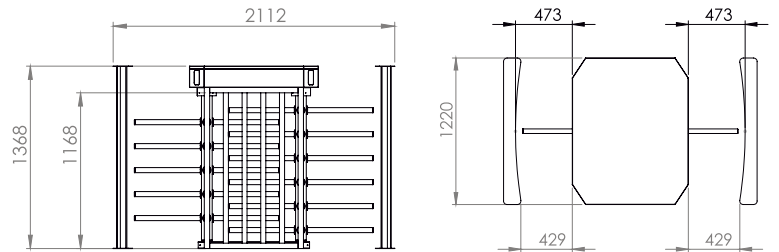

Product Specifications: Stainless Steel, painted

Technical Specifications

Operation: Adjustable manual switching in both directions

Body: 1.2 mm thick stainless steel. Optional: Electrostatic powder coating with different color options.

Handles: Electrostatic powder coating with Ø38 mm diameter stainless steel or different colour options

IP Class: IP54 (Op. IP56)

Operating Temperature: Between (-20°C) and (+68°C) Op: with -50°C heater

Functions: Switching time adjustable, adjustable switching directions, memory mode, audible alarm

Emergency: In case of all kinds of disasters and emergencies, the handles run idle.

Power Supply: 110/220V – 50/60 Hz AC (%10 +-)

Power Consumption: 24V DC standby 12W max 60W 7W max 14W. Power supply system (SMPS) with the feature of filtering fluctuations likely to occur in electrical lines.

Transition Range: 510 mm

Safety Level: High Security

Indicators: Bidirectional double colour led panel

Accessories: Heater, battery unit, led spot lighting, dry contact or systems that can be controlled by any voltage between TTL CMOS 5-48V.

Control System: Compatible with all kinds of Access control units and token systems. Opt. Functions can be controlled with RS232-485 or LAN (network).